

iGET

HME

Gateway GW6

User Guide - EN

Product Introduction

This in-wall smart control panel adopts the Android platform, it mainly provides gateway functions and scene mode functions. By installing it in the wall electrical box at the user's home, users can manage their smart home devices through the screen touch or mobile APP **iGET HOME** control.

Appearance

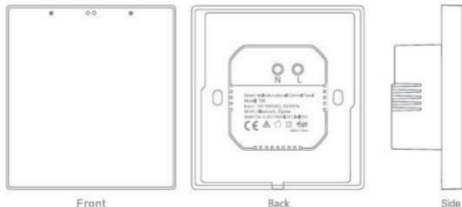

Interface and Ports

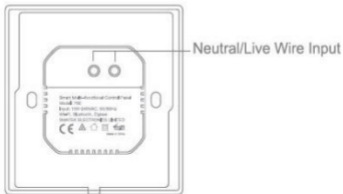
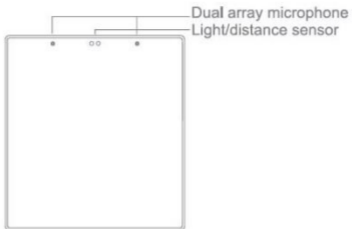

Installation Preparations

- 1) This product is powered by the neutral wire and live wire, please well arrange neutral wire in advance.
- 2) This product connects to the network via Wi-Fi, please set up the Wi-Fi network in advance.
- 3) Please prepare your own tools such as screwdriver electric tester, electrical tape and so on.
- 4) To ensure electricity safety and wireless performance, please use plastic wall electrical box instead of the metallic.
- 5) Please do not operate it under electricity.

Safety Notes

- This product must be installed by professional electricians.
- Turn off the main power in the electricity box and make sure the live wire is not alive with a test pencil.
- This product should be kept away from fire and water during installation and use.
- This product can not be used in moisture circumstances such as bathroom.

Installation instructions

- Turn off the main power in the electricity box and make sure the live wire in wall electrical box is not alive with a test pencil.
- Remove the base of the smart switch and install it in the wall box (shown in the pictures following).

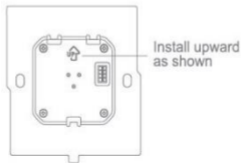
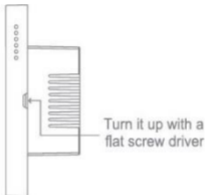

Installation instructions

Wires connection instructions

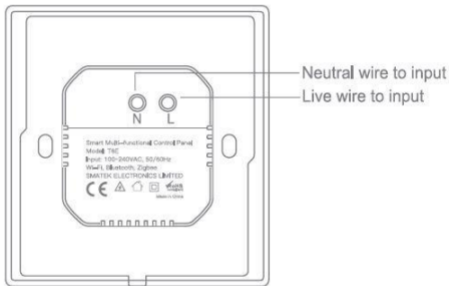

Note: Make sure the circuit power were cut off before wires connections!

Installation instructions

- Check the wires and make sure the wires are in good contact with the terminals and no exposed copper wires.
- Fasten the base to the wall electrical box with mounting screws and fix the smart switch back to the base.
- Note that the screws should not be fixed too tight during installation in case any deformation or damage to the screen and hardware.
- If the smart switch GW6 is not flat after installation, do not press the screen violently, please check the wall box and the base installation first.

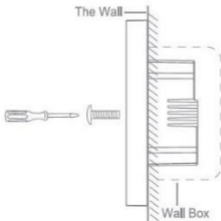

Network Settings

- 1) Search for the iGET HOME APP from App store, Google Play, or scan the QR code from the user manual to download and install App, if you download and use it for the first time, please click the "Sign Up" button to register an account, if you already have an account, click the "Log In" button.
- 2) After installing the product according to the installation guide, turn on the power and wait for the product to start, and connect to the network according to the instructions on the product screen.
- 3) Open the installed App and scan the QR code on product screen to pair with the product. After successfully paired, operate as per the Instructions shown on the product screen. Confirming the QR Code according to the actual display on product screen.

User Manual

- Scenes Overview: Enter the "Gateway GW6" page of the App, add the devices or scenes that need to be displayed on the screen, and confirm it according to the actual interface of the APP.
- Gateway function: Enter the "Gateway GW6" page of the App, add Zigbee devices, and confirm it according to the actual interface of the APP.
- Settings: Slide down at the top of the GW6 screen to find the setting page.

Product Specifications

Product name	iGET HOME Gateway GW6
Product model	GW6
Input power	100~240 VAC, 50/60 Hz
Working temperature	0°C~+40°C
Working humidity	5%~90% RH (non-condensing)
Wireless Protocol	Wi-Fi, Bluetooth, Zigbee
Dimensions	86 x 86 x 36 mm
Net Weight	178 g

Packing List

- iGET HOME Gateway GW6
- User manual
- Mounting Screw 2x

App iGET HOME:



Google Play



App Store

Warranty Rules

For household use: The given symbol (crossed-out wheeled bin) on the product or at accompanying documents means that used electrical and electronic products should not be disposed of with household waste. To ensure proper disposal of the product, hand it over to a designated collection point, where it will be accepted free of charge. The correct disposal of this product will help to save valuable natural resources and prevent any potential negative impacts on the environment and human health, which could otherwise be caused by inappropriate disposal of wastes. For more details, please, contact your local authorities or the nearest collection point. The improper disposal of this waste can be penalized in accordance with national regulations. Information for users to disposal of electrical and electronic devices (corporate and business use): For proper disposal of electrical and electronic devices, ask for details from your dealer or distributor. Information for users to disposal of electrical and electronic devices in other countries outside.



EU: The above mentioned symbol (crossed-out wheeled bin) is valid only in the countries of EU. For proper disposal of electrical and electronic devices, ask for details from your authorities or dealer. All is expressed by the symbol of crossed-out wheeled bin on product, packaging or in printed materials.

Set up the claim for warranty repair of device at your dealer. If you have technical questions or problems, contact your dealer. Follow the rules for working with electrical equipment. The user may not dismantle the device or replace any part of

this. Opening or removing the covers poses the risk of electric shock. In case of incorrect reassembly and subsequent connection you are also exposed to electric shock.

Declaration of Conformity:

Company INTELEK.CZ s.r.o. hereby declares that all GW6 devices are in compliance with essential requirements and other relevant provisions of Directive 2014/53/EU. The full text of the EU Declaration of Conformity is available on this website www.iget.eu.

The warranty period of the product is 24 months, unless stated otherwise.

This device can be used in the following countries bellow.

Italy - The conditions for using the WiFi network are described in the so-called Electronic Communications Code

Norway - The 2.4 GHz limitation applies only to the area 20 km from colony of Ny-Ålesund.

RoHS: The components used in the device meet the requirements on the restriction of hazardous substances in electrical and electronic devices in accordance with Directive 2011/65/EU. The RoHS declaration can be downloaded from www.iget.eu.

Operation of radio equipment:

CZ: This radio equipment can be operated in the Czech Republic under the General Authorizations VO-R / 1 / 05.2017-2 and VO-R / 12 / 09.2010-12.



SK: This radio equipment can be operated under General Authorizations VPR - 07/2014, VPR - 02/2017 and VPR - 35/2012.

Producer / Exclusive importer of iGET products to EU: INTELEK.CZ s.r.o., Olivova
2096/4, Nové Město – Praha 1, CZ web: <http://www.iget.eu>
SUPPORT: <http://www.iget.eu/helpdesk>
Copyright© 2022 INTELEK.CZ s.r.o. All rights reserved.

AT	BE	CY	CZ	DK	EE	FI	MT	NL	PL	PT	SK
SI	ES	DE	GR	HU	IE	IT	LV	LT	GB	IS	LI
NO	CH	BG	HR	RU	RO	FR	SE	LU	TR		

Please read the instruction manual carefully before using the product